

Technical Appendix 10.3: Protected Species Survey

Figure 4.1: Bat Survey Methods and BRP Results

- Overhead line infrastructure**
- Polquhanity to Glenlee via Kendoon (steel lattice tower)
  - Existing tower for removal
  - Existing 132kV overhead line to be removed (following construction of the KTR Project)
  - Existing network
  - Access point
- Access to proposed towers**
- Existing access
  - New access
  - Timber extraction spur
- Access to towers for removal**
- New access
  - Working area
  - Construction compound
  - Potential quarry working area
- Bat Protected Species Survey**
- Study area
  - Anabat location
  - Bat Transect - Driven August 2017
  - Bat Transect - Driven June 2017
  - Woodland with multiple trees with BRP

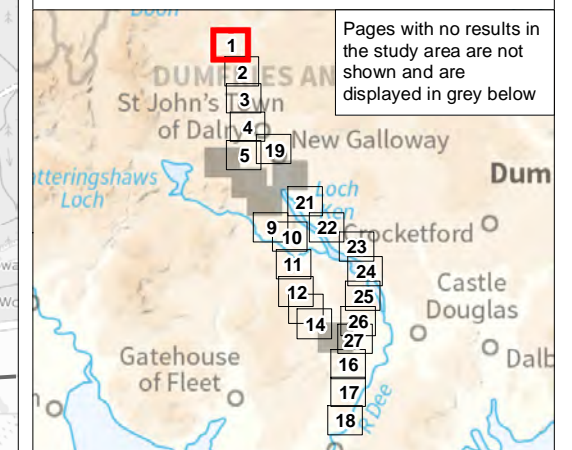
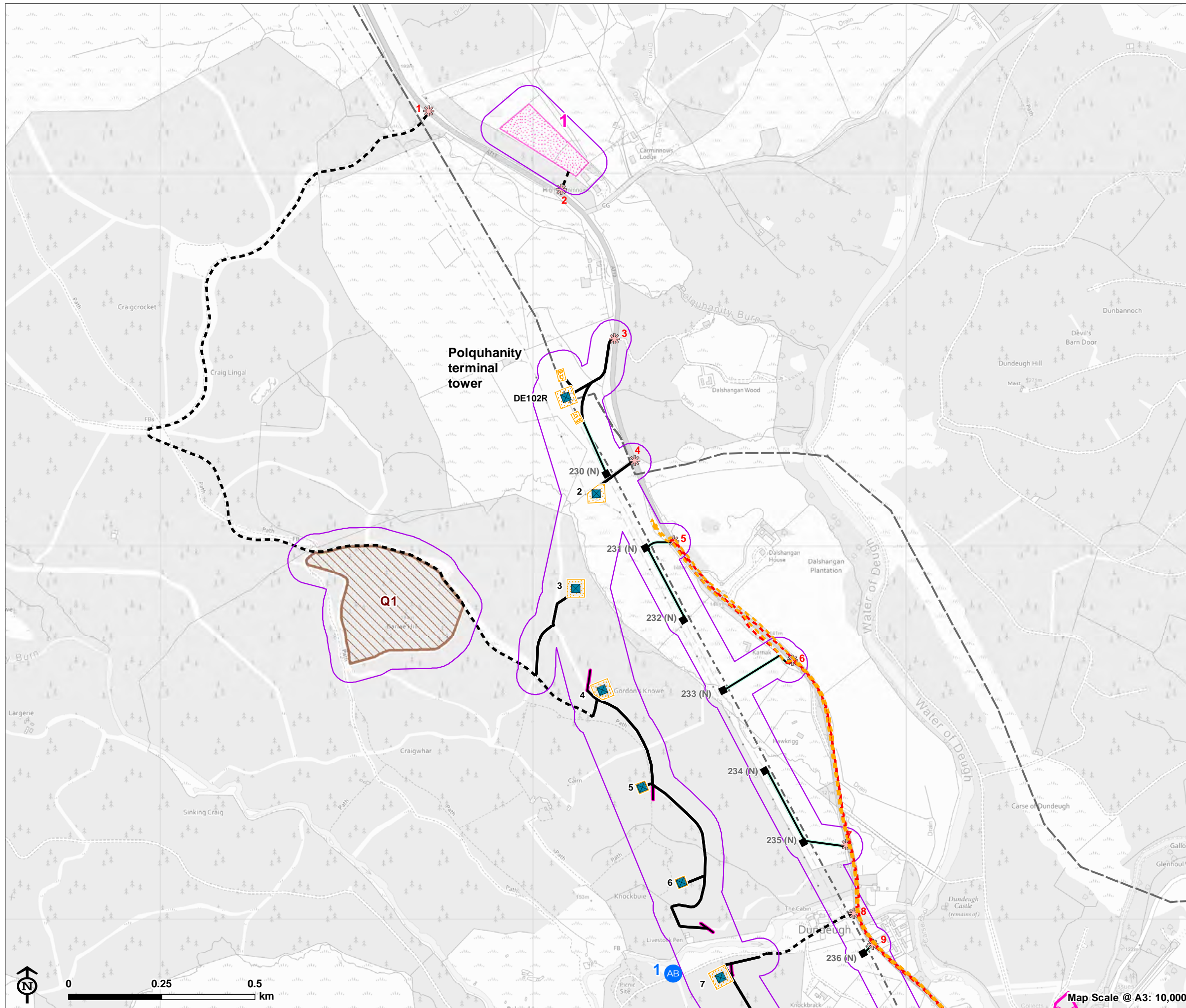

Technical Appendix 10.3: Protected Species Survey

Figure 4.2: Bat Survey Methods and BRP Results

- Overhead line infrastructure**
- Polquhanity to Glenlee via Kendoon (steel lattice tower)
  - Carsfad to Kendoon (wood pole)
  - Existing tower for removal
  - Existing 132kV overhead line to be removed (following construction of the KTR Project)
  - Access point
- Access to proposed towers**
- Existing access
  - New access
  - Timber extraction spur
- Access to towers for removal**
- New access
- Bat Protected Species Survey**
- Study area
  - Anabat location
  - Bat Transect - Driven August 2017
  - Bat Transect - Driven June 2017
- Tree with Bat Roost Potential (BRP)**
- BRP High
  - BRP Low
  - Woodland with multiple trees with BRP

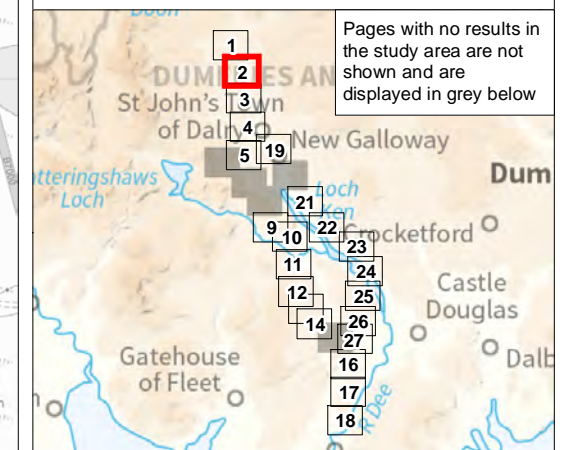
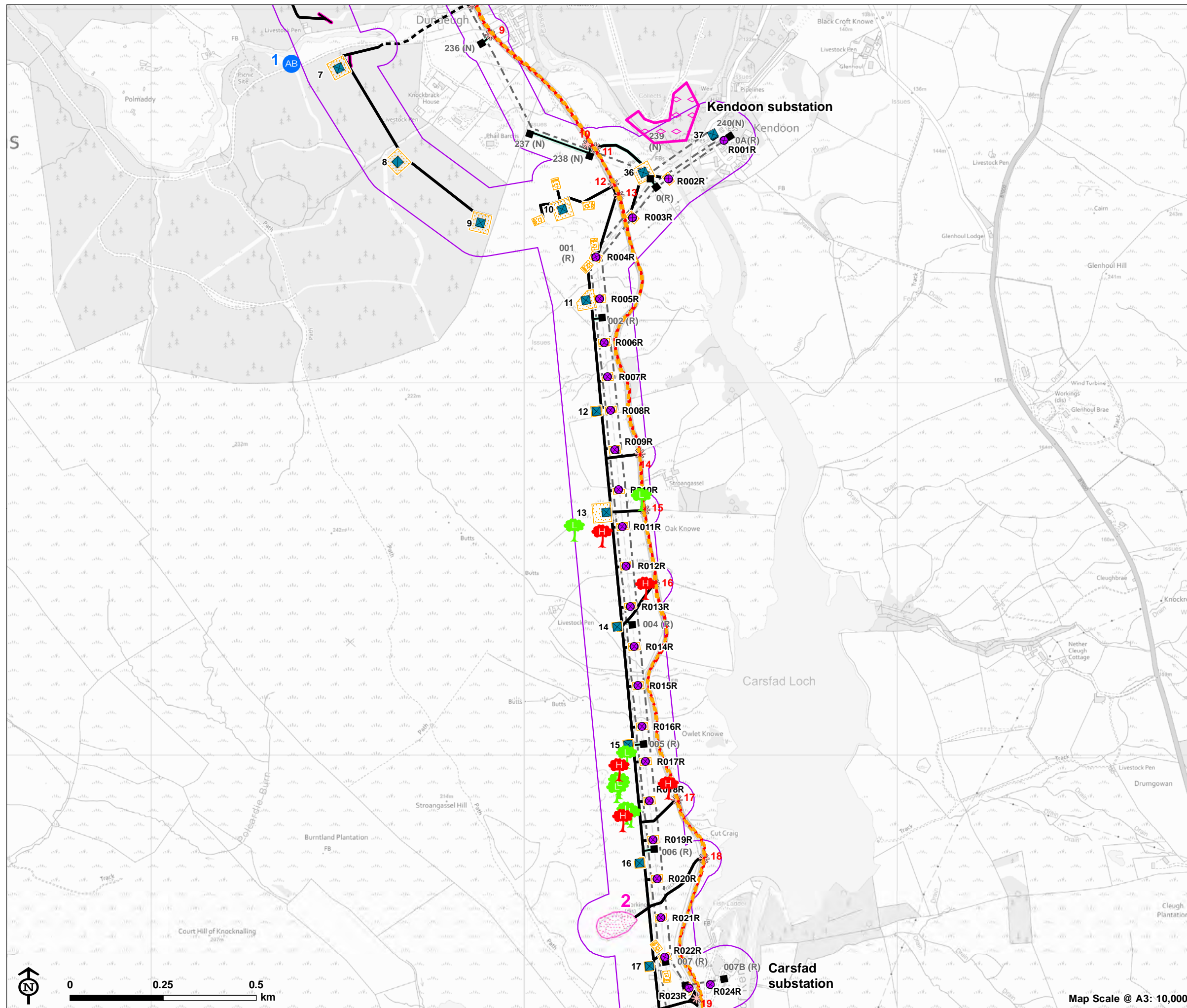

Pages with no results in the study area are not shown and are displayed in grey below

**Technical Appendix 10.3: Protected Species Survey**

**Figure 4.3: Bat Survey Methods and BRP Results**

- Overhead line infrastructure**
- Polquhanity to Glenlee via Kendoon (steel lattice tower)
  - Carsfad to Kendoon (wood pole)
  - Existing tower for removal
  - Existing 132kV overhead line to be removed (following construction of the KTR Project)
  - Access point
- Access to proposed towers**
- Existing access
  - New access
  - Timber extraction spur
- Access to towers for removal**
- Existing access
  - New access
- Working area**
- Working area
  - Construction compound
- Bat Protected Species Survey**
- Study area
  - Bat Transect - Driven August 2017
  - Bat Transect - Driven June 2017
- Structure with Bat Roost Potential (BRP)**
- BRP High
- Tree with Bat Roost Potential (BRP)**
- BRP High
  - BRP Low
  - Woodland with multiple trees with BRP

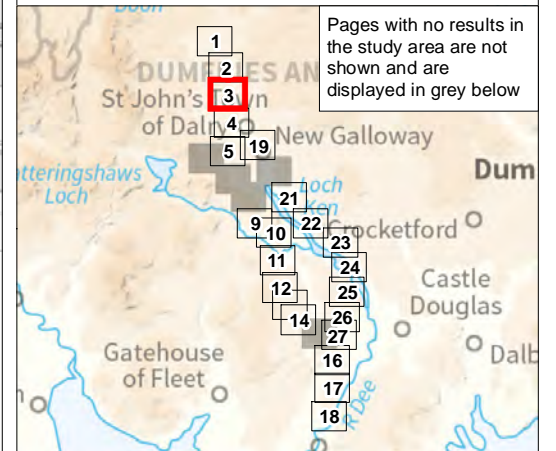
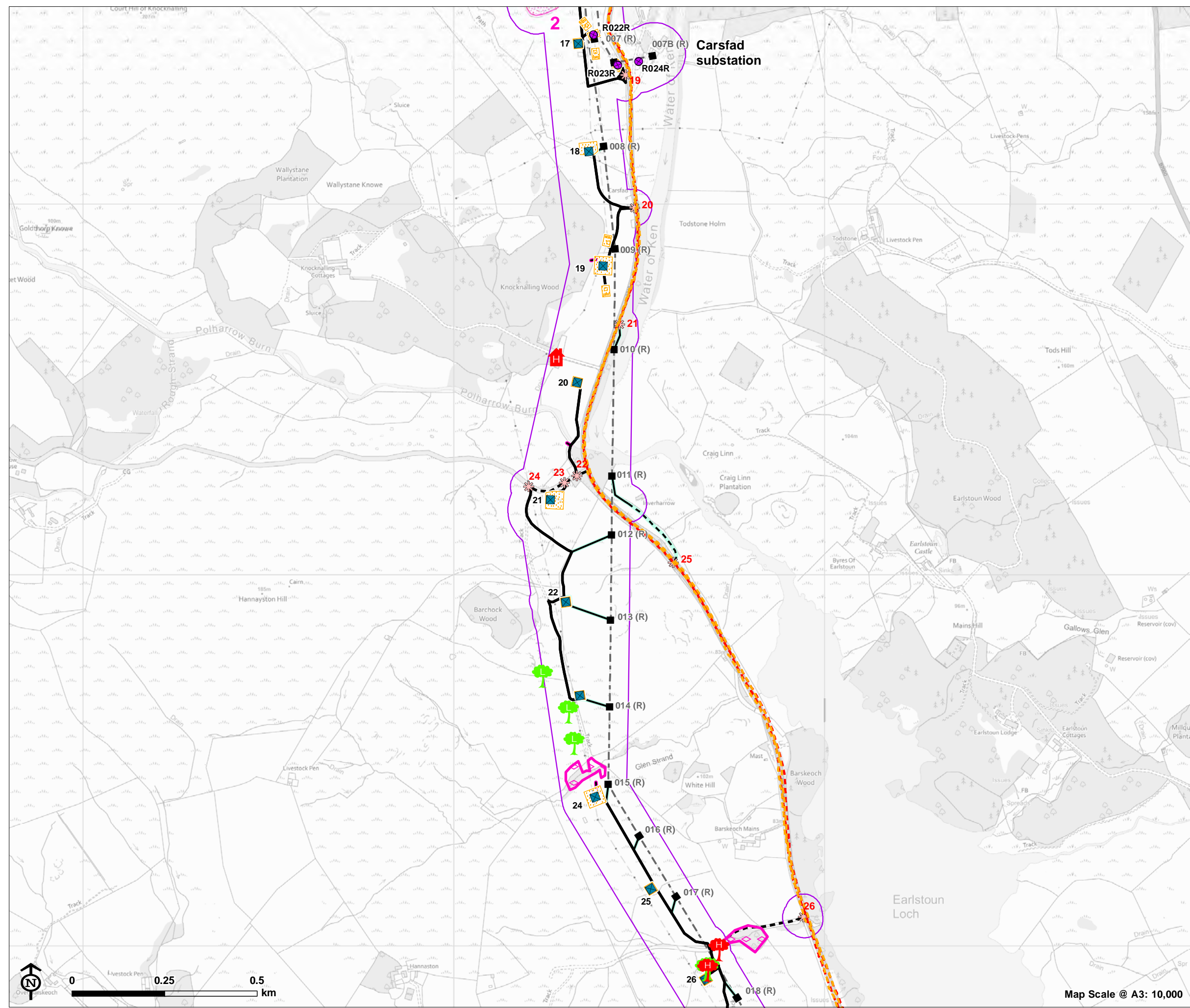

Map Scale @ A3: 10,000



**Technical Appendix 10.3: Protected Species Survey**

**Figure 4.4: Bat Survey Methods and BRP Results**

- Overhead line infrastructure**
- Polquharity to Glenlee via Kendon (steel lattice tower)
  - Earlstoun to Glenlee (wood pole)
  - Earlstoun to Glenlee (temporary wood pole)
  - Glenlee to Tongland (steel lattice tower)
  - BG route deviation (steel lattice tower)
  - Existing tower for removal
  - Existing 132kV overhead line to be removed (following construction of the KTR Project)
  - Underground cable
  - Access point
- Access to proposed towers**
- Existing access
  - New access
  - Timber extraction spur
- Access to towers for removal**
- Existing access
  - New access
  - Working area
- Bat Protected Species Survey**
- Study area
  - Anabat location
  - Bat Transect - Driven August 2017
  - Bat Transect - Driven June 2017
- Structure with Bat Roost Potential (BRP)**
- BRP Low
- Tree with Bat Roost Potential (BRP)**
- BRP High
  - BRP Moderate
  - BRP Low
  - Woodland with multiple trees with BRP

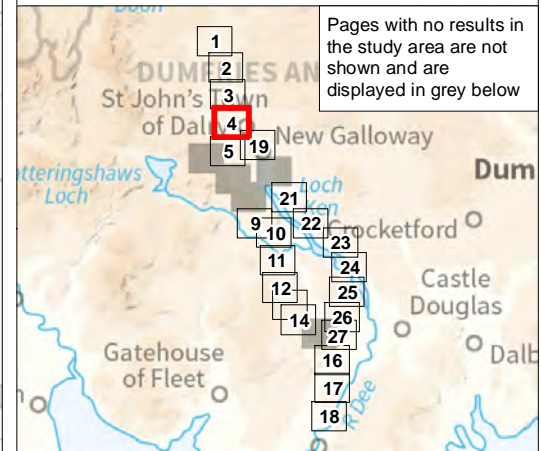
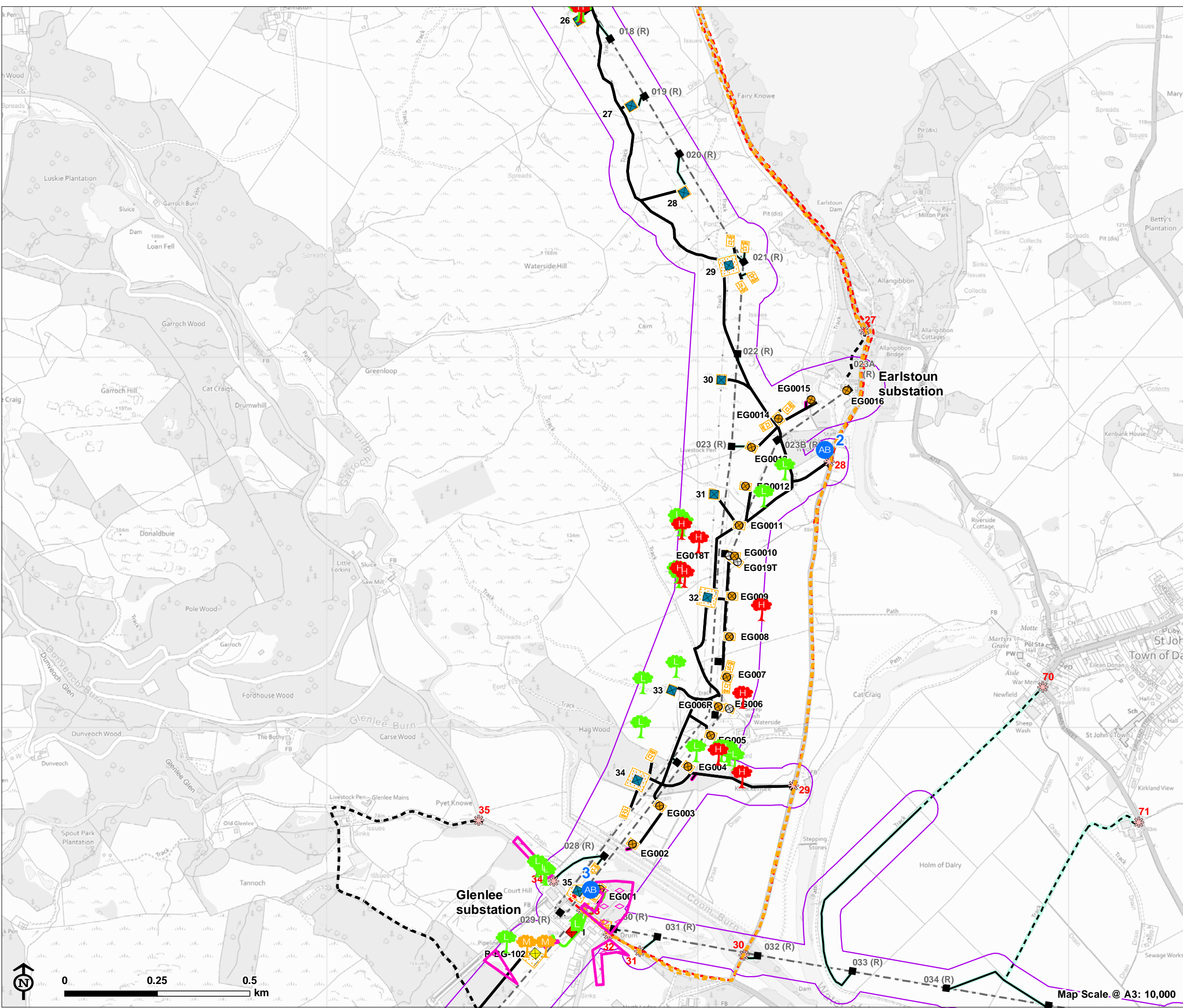

Map Scale @ A3: 10,000

**Technical Appendix 10.3: Protected Species Survey**

**Figure 4.5: Bat Survey Methods and BRP Results**

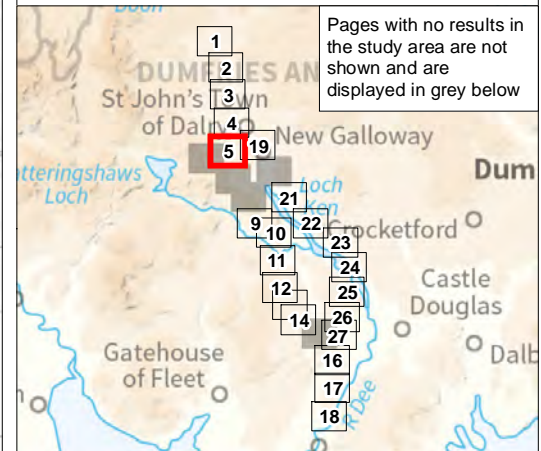
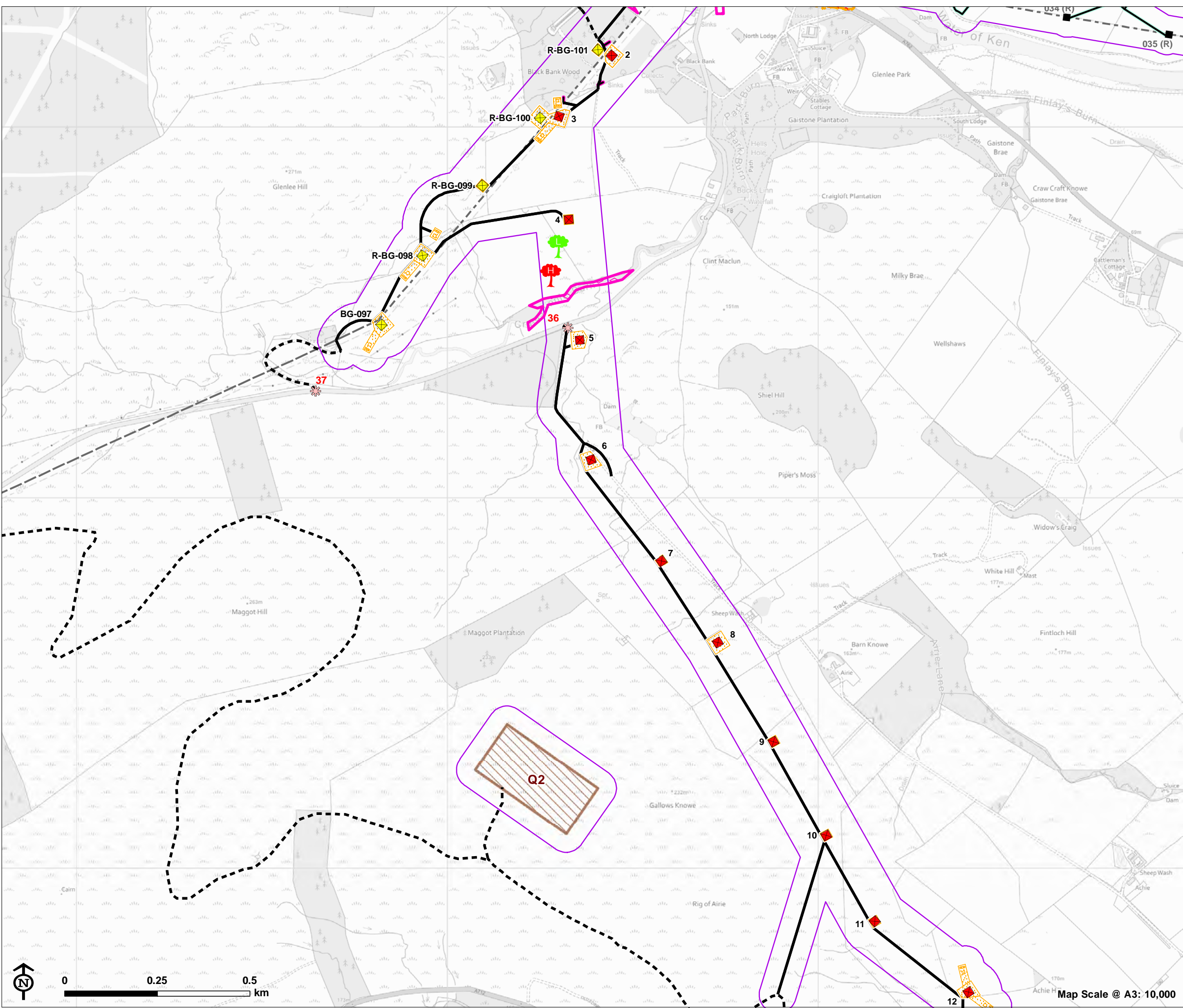



Technical Appendix 10.3: Protected Species Survey

Figure 4.10: Bat Survey Methods and BRP Results

- Overhead line infrastructure**
- Glenlee to Tongland (steel lattice tower)
  - ✱ Access point
- Access to proposed towers**
- - - Existing access
  - New access
  - Timber extraction spur
- Working areas**
- ▨ Working area
  - ▨ Construction compound
- Bat Protected Species Survey**
- ▭ Study area
  - Bat Transect - Walked August 2017
  - Bat Transect - Walked July 2017

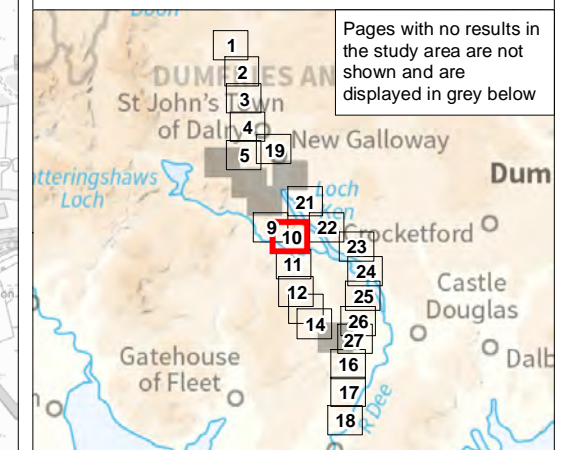
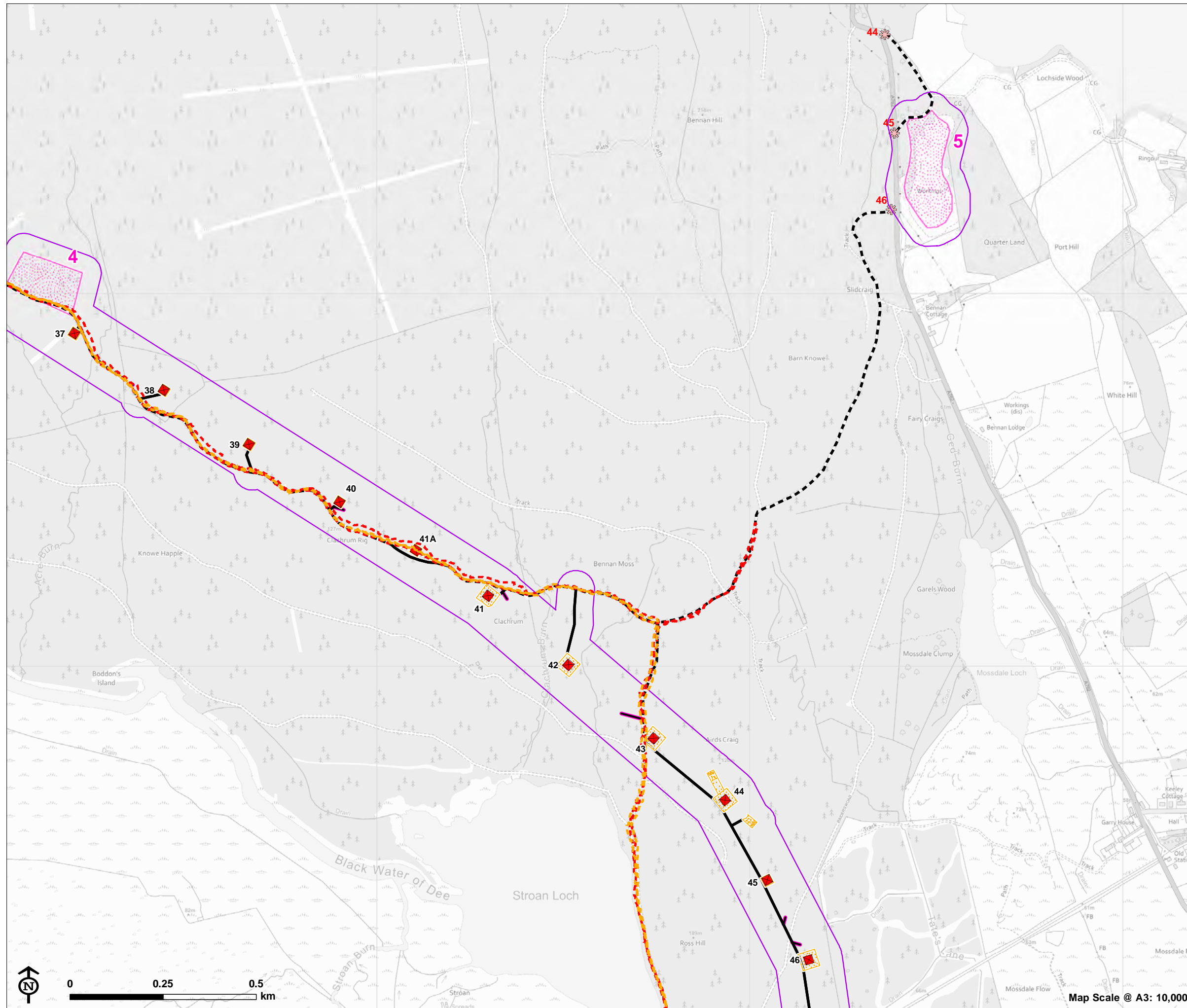

Pages with no results in the study area are not shown and are displayed in grey below



Technical Appendix 10.3: Protected Species Survey

Figure 4.11: Bat Survey Methods and BRP Results

- Overhead line infrastructure**
- Glenlee to Tongland (steel lattice tower)
- Access to proposed towers**
- - - Existing access
  - New access
  - Timber extraction spur
- Working area**
- ▨ Working area
- Bat Protected Species Survey**
- ▭ Study area
  - AB Anabat location
  - Bat Transect - Walked August 2017
  - - - Bat Transect - Walked July 2017

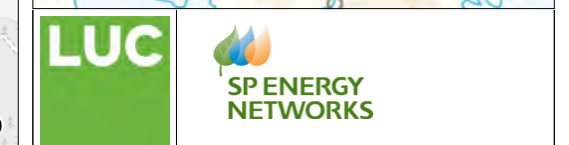
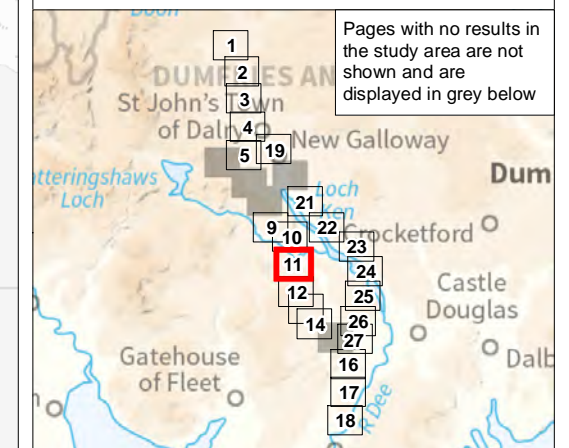
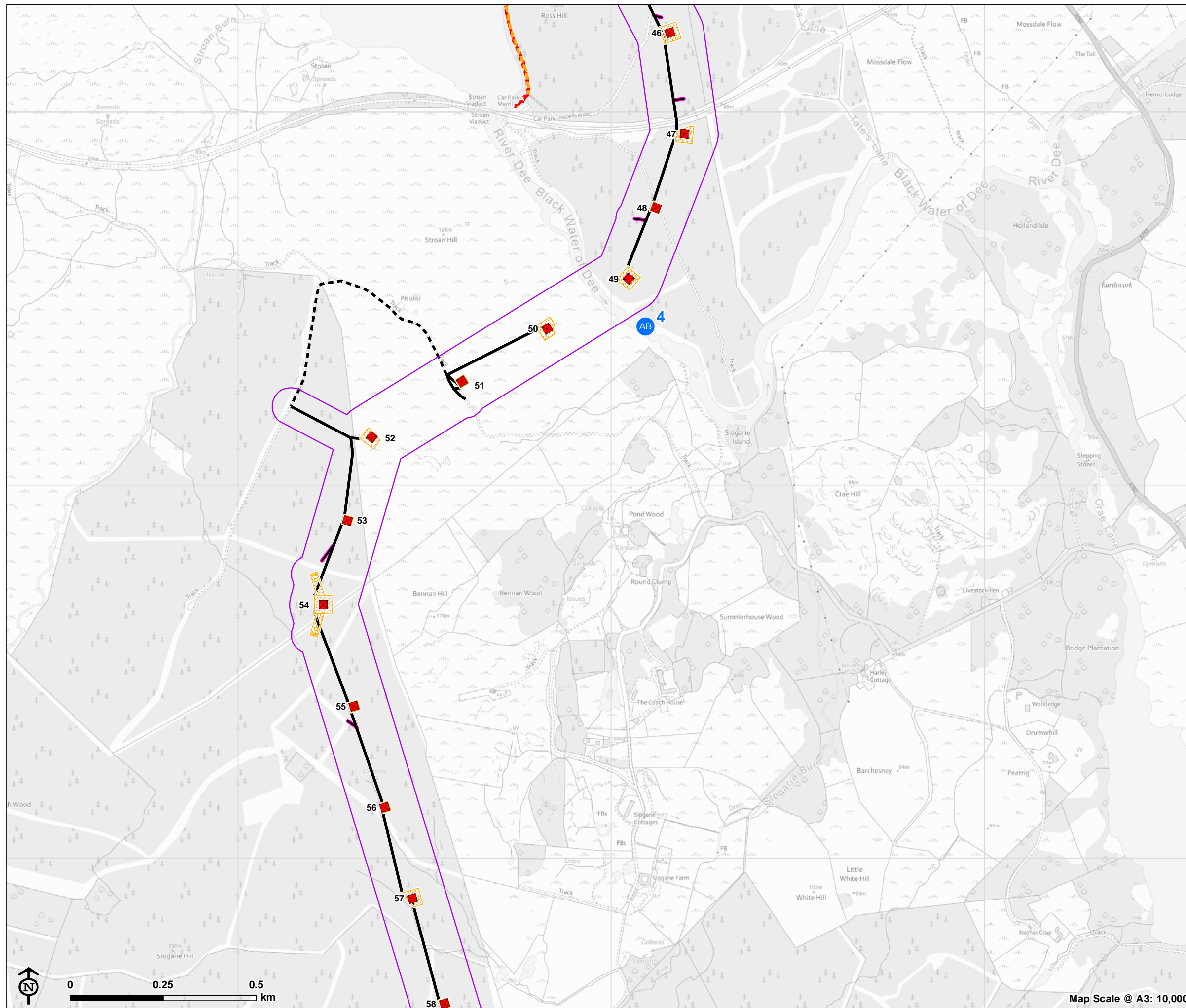



Technical Appendix 10.3: Protected Species Survey

Figure 4.12: Bat Survey Methods and BRP Results

- Overhead line infrastructure**
- Glenlee to Tongland (steel lattice tower)
  - ✱ Access point
- Access to proposed towers**
- - - Existing access
  - New access
  - Timber extraction spur
  - ▨ Working area
  - ▨ Potential quarry working area
- Bat Protected Species Survey**
- Study area
  - AB Anabat location
- Tree with Bat Roost Potential (BRP)**
- 🌳 BRP High
  - 🌳 BRP Moderate
  - 🌳 BRP Low

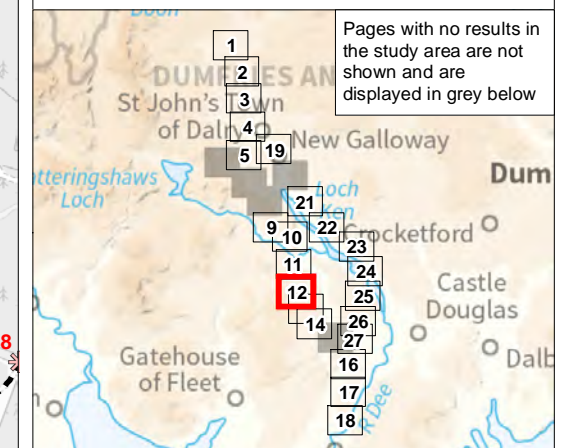
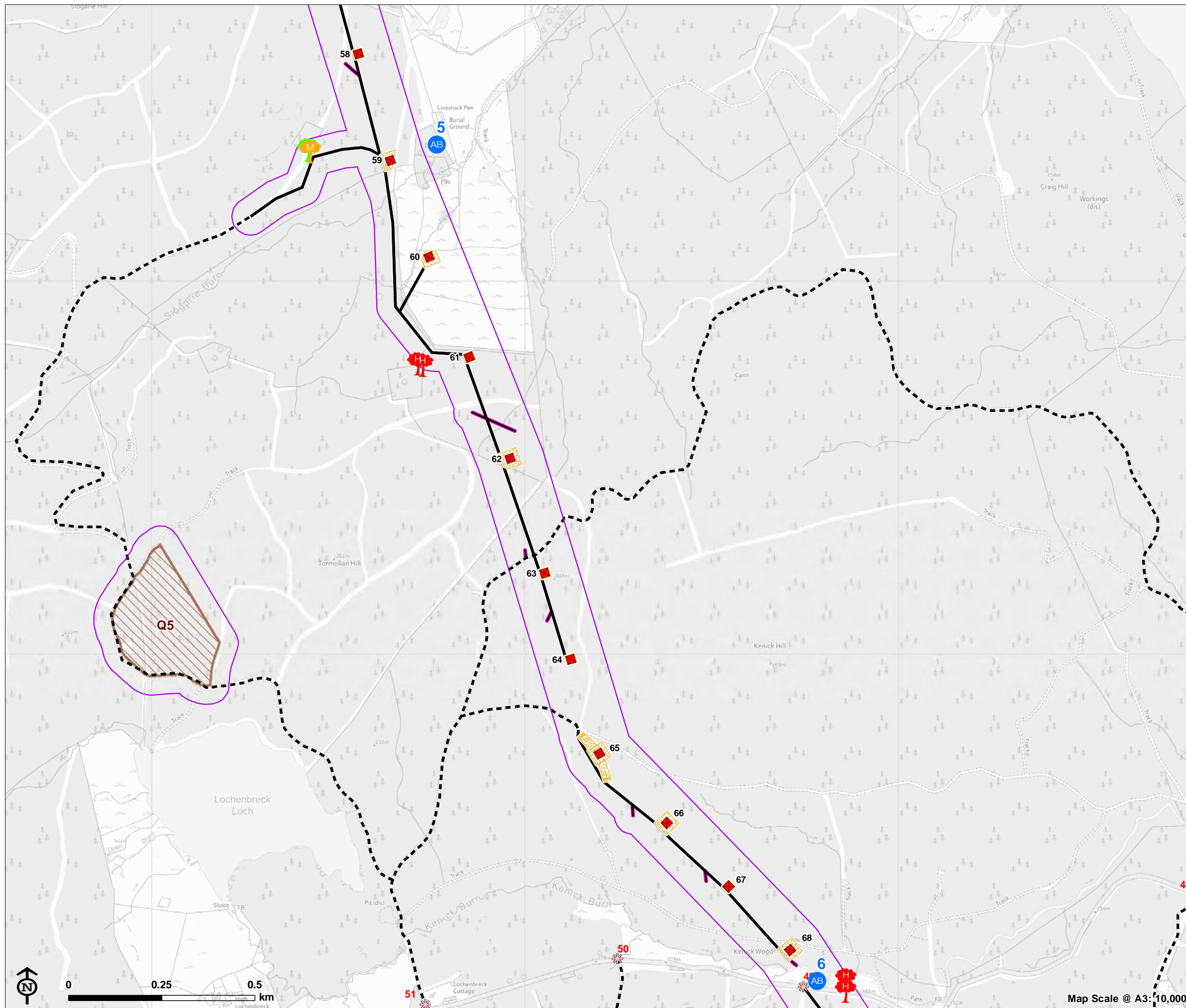

Pages with no results in the study area are not shown and are displayed in grey below

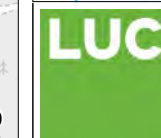

Map Scale @ A3: 10,000

Technical Appendix 10.3: Protected Species Survey

Figure 4.13: Bat Survey Methods and BRP Results

- Overhead line infrastructure**
- Glenlee to Tongland (steel lattice tower)
  - ✱ Access point
- Access to proposed towers**
- - - Existing access
  - New access
  - Timber extraction spur
  - ▨ Working area
  - ▨ Potential quarry working area
- Bat Protected Species Survey**
- Study area
  - AB Anabat location
- Tree with Bat Roost Potential (BRP)**
- 🌳 BRP High

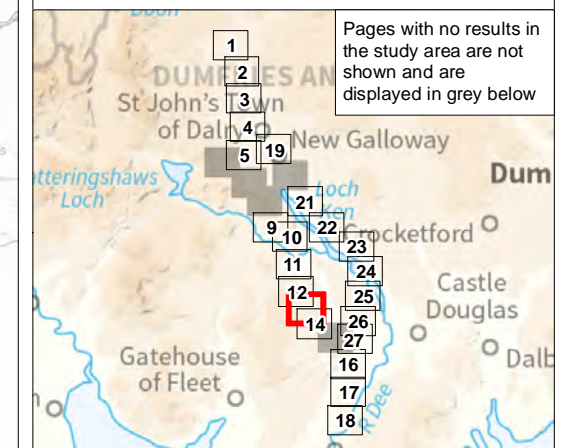

Pages with no results in the study area are not shown and are displayed in grey below



Technical Appendix 10.3: Protected Species Survey

Figure 4.14: Bat Survey Methods and BRP Results

- Overhead line infrastructure**
- Glenlee to Tongland (steel lattice tower)
  - ✱ Access point
- Access to proposed towers**
- - - Existing access
  - New access
  - Timber extraction spur
- Working areas**
- ▨ Working area
  - ▨ Construction compound
  - ▨ Potential quarry working area
- Bat Protected Species Survey**
- ▭ Study area
  - AB Anabat location

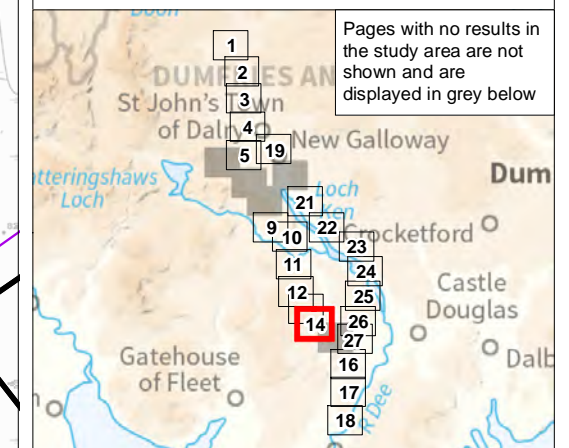
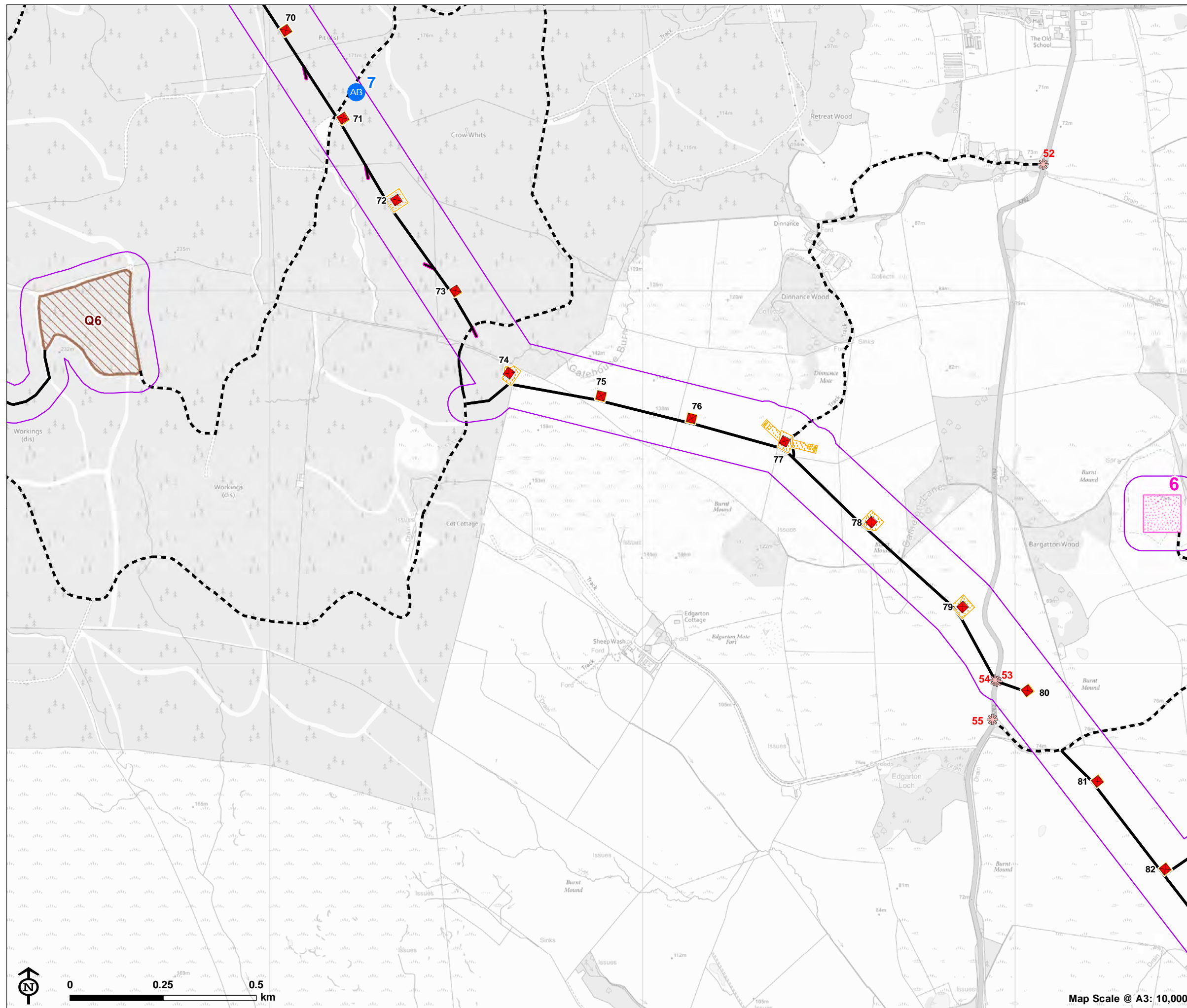

Technical Appendix 10.3: Protected Species Survey

Figure 4.16: Bat Survey Methods and BRP Results

- Overhead line infrastructure**
- Glenlee to Tongland (steel lattice tower)
  - Existing tower for removal
  - - - Existing 132kV overhead line to be removed (following construction of the KTR Project)
  - ✱ Access point
- Access to proposed towers**
- - - Existing access
  - New access
- Access to towers for removal**
- Existing access
  - New access
- Working area**
- ▨ Working area
- Bat Protected Species Survey**
- ▭ Study area
  - AB Anabat location
- Tree with Bat Roost Potential (BRP)**
- M BRP Moderate
  - L BRP Low
  - ▭ Woodland with multiple trees with BRP

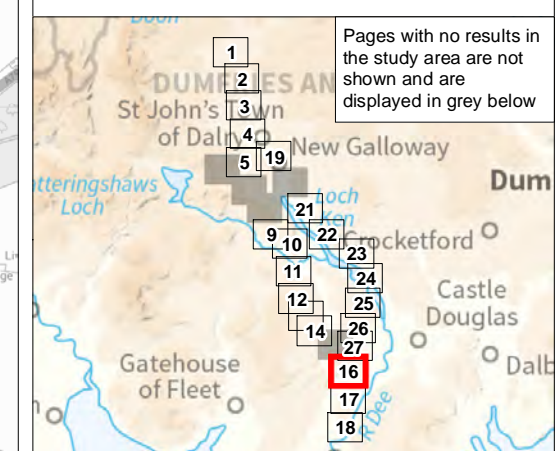
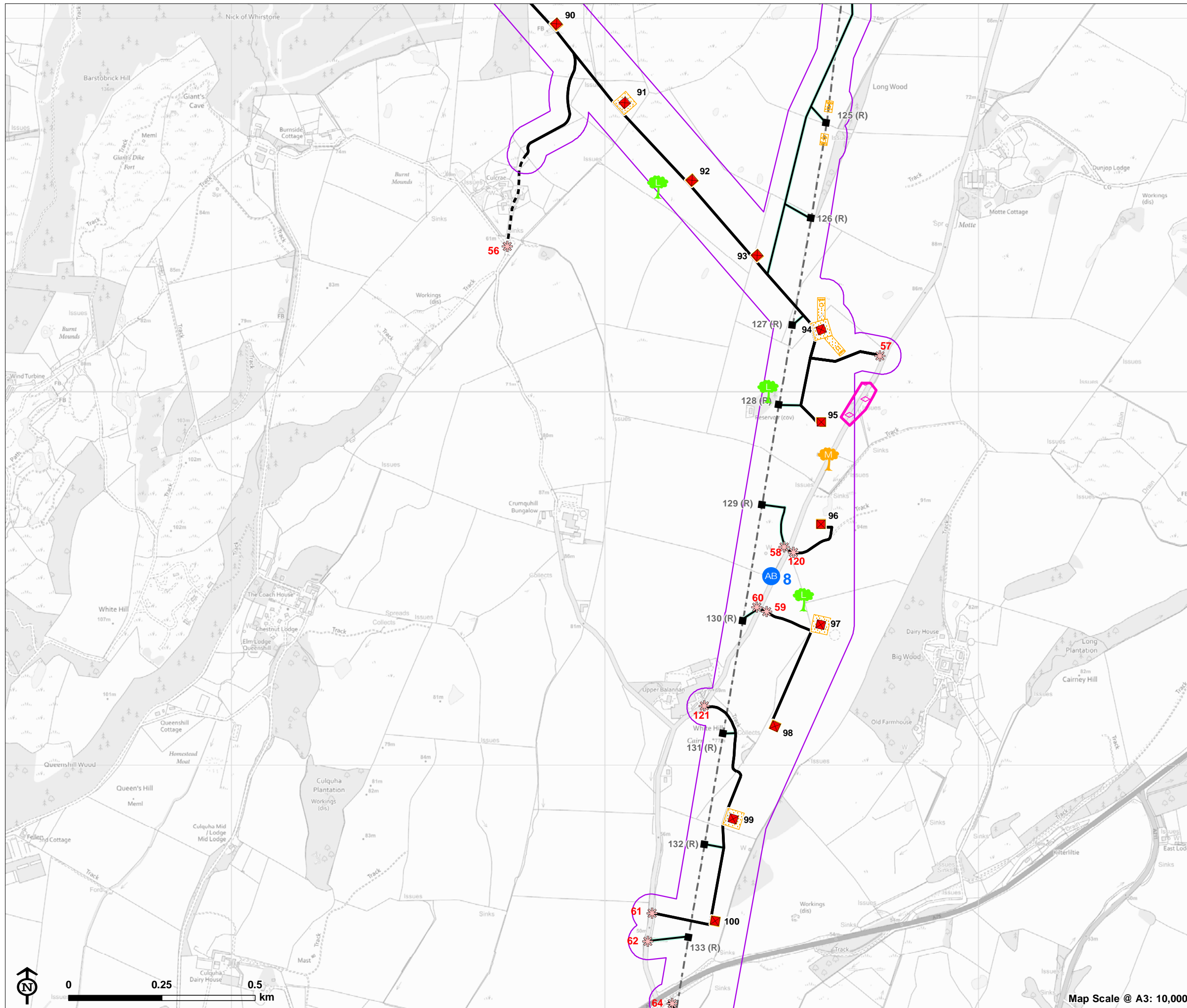

Pages with no results in the study area are not shown and are displayed in grey below

**Technical Appendix 10.3: Protected Species Survey**

**Figure 4.17: Bat Survey Methods and BRP Results**

- Overhead line infrastructure**
- Glenlee to Tongland (steel lattice tower)
  - Existing tower for removal
  - - - Existing 132kV overhead line to be removed (following construction of the KTR Project)
  - ✱ Access point
- Access to proposed towers**
- - - Existing access
  - New access
  - Timber extraction spur
- Access to towers for removal**
- New access
  - Working area
- Bat Protected Species Survey**
- Study area
  - AB Anabat location
- Tree with Bat Roost Potential (BRP)**
- BRP High

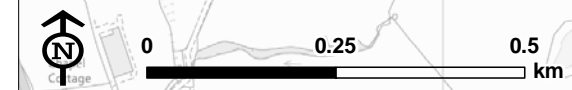
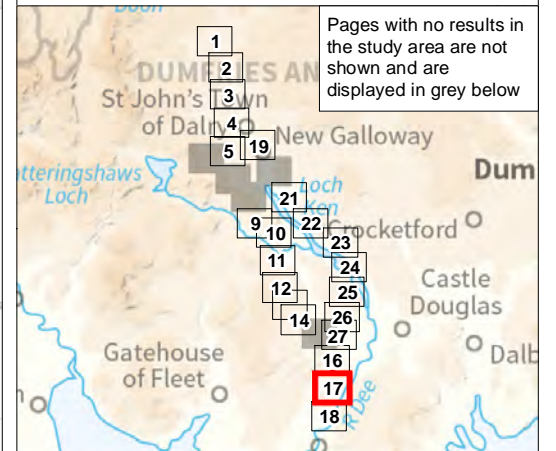
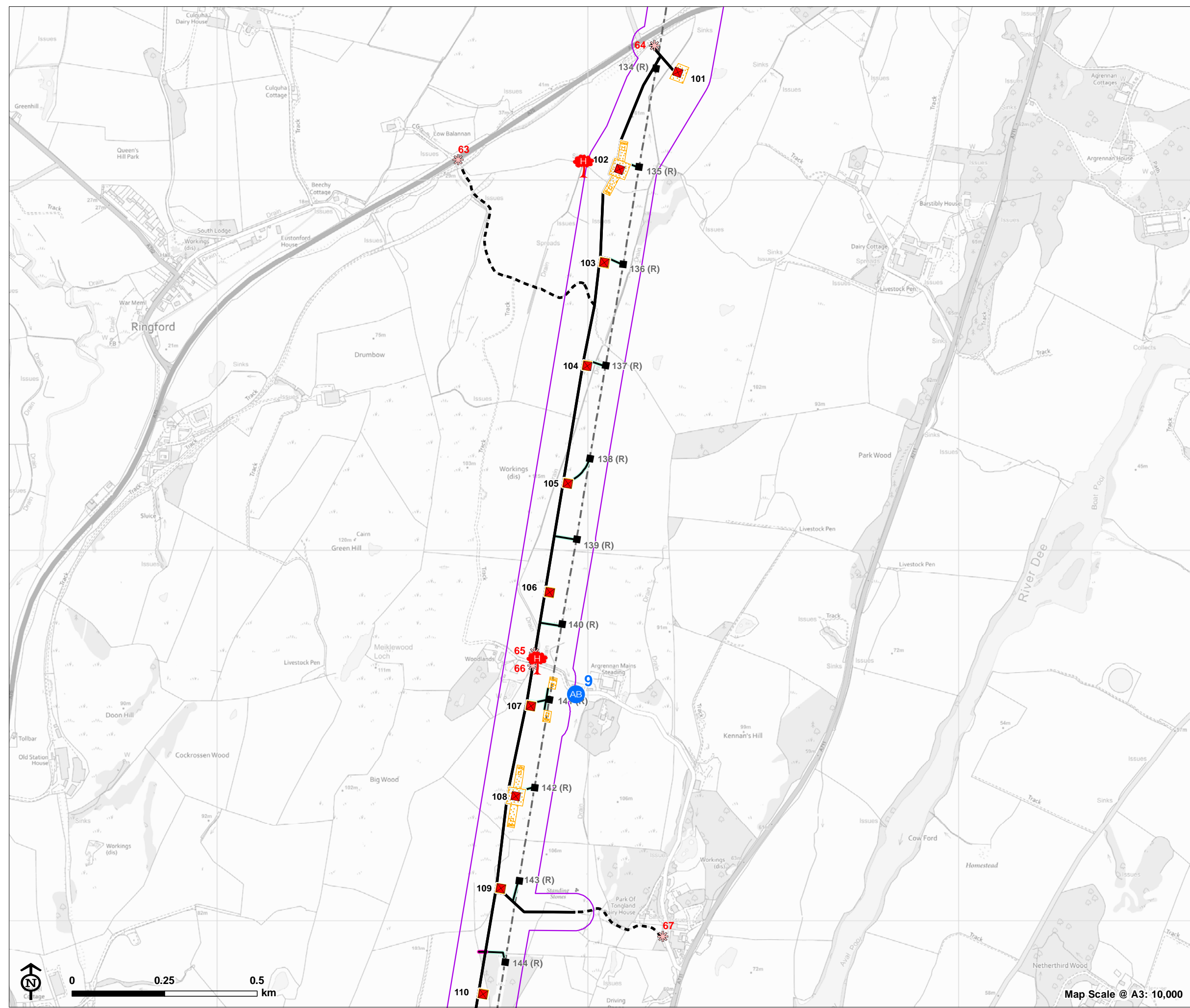

Map Scale @ A3: 10,000



Technical Appendix 10.3: Protected Species Survey

Figure 4.18: Bat Survey Methods and BRP Results

- Overhead line infrastructure**
- Glenlee to Tongland (steel lattice tower)
  - Existing tower for removal
  - - - Existing 132kV overhead line to be removed (following construction of the KTR Project)
  - - - Existing network
  - ✱ Access point
- Access to proposed towers**
- - - Existing access
  - New access
- Access to towers for removal**
- New access
- Working area**
- ▨ Working area
- Bat Protected Species Survey**
- ▭ Study area
  - AB Anabat location
- Tree with Bat Roost Potential (BRP)**
- 🌳 BRP Low

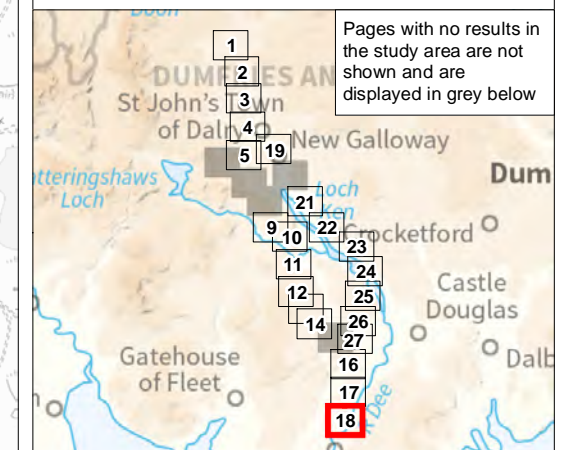
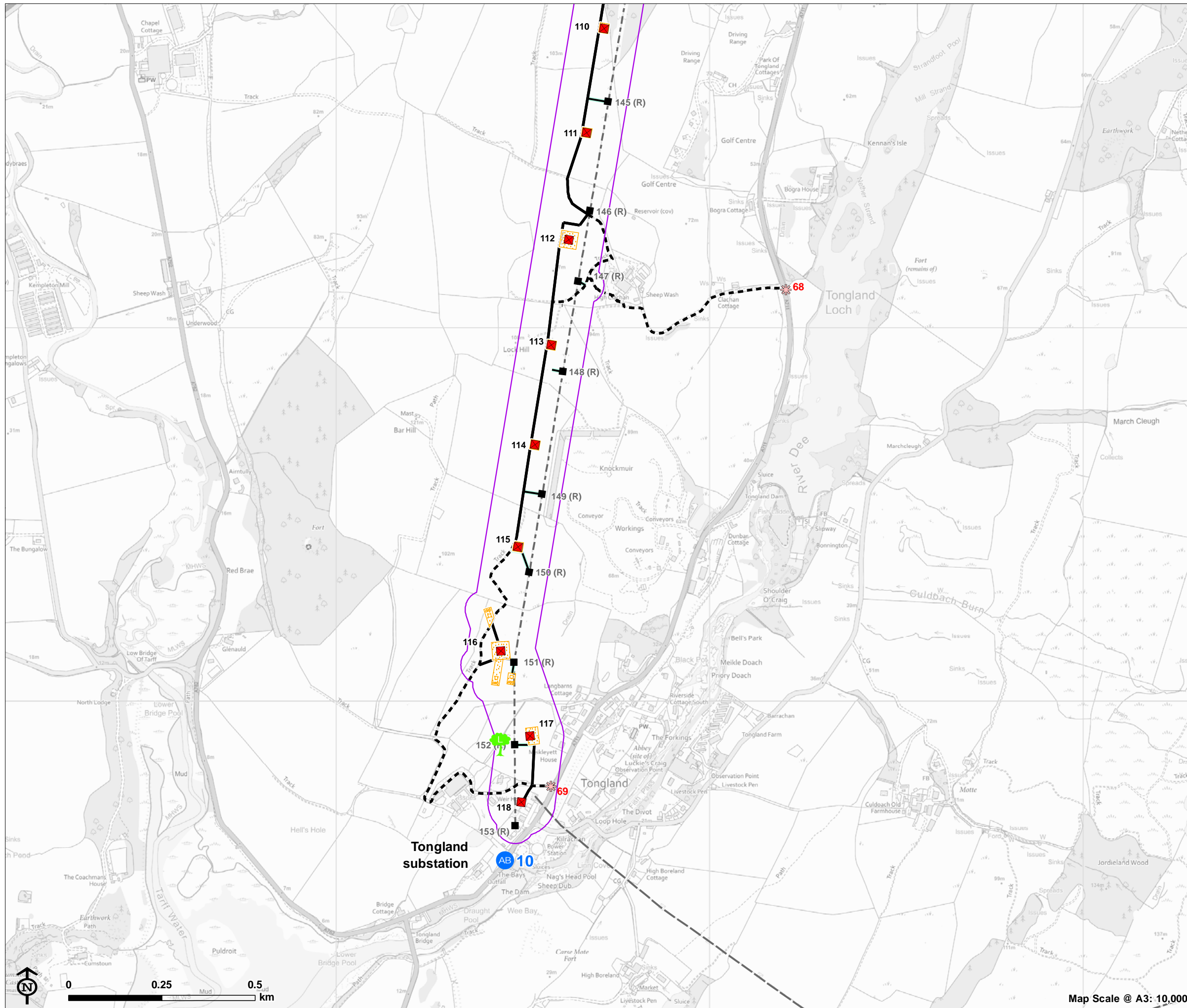

Technical Appendix 10.3: Protected Species Survey

Figure 4.19: Bat Survey Methods and BRP Results

- Overhead line infrastructure**
- Existing tower for removal
  - - - Existing 132kV overhead line to be removed (following construction of the KTR Project)
  - ✱ Access point
- Access to towers for removal**
- - - Existing access
  - New access
  - Working area
- Bat Protected Species Survey**
- Study area
- Structure with Bat Roost Potential (BRP)**
- BRP Moderate
  - BRP Low
- Tree with Bat Roost Potential (BRP)**
- BRP High
  - BRP Moderate
  - BRP Low

