

REPRODUCED FROM ORDNANCE SURVEY MAP NN22SE
BY PERMISSION OF THE ORDNANCE SURVEY ON BEHALF OF THE CONTROLLER
OF HER MAJESTY'S STATIONERY OFFICE.
© CROWN COPYRIGHT ORDNANCE SURVEY, LICENCE No. 0100052046.

E

Designer's Site Specific Risk Assessment

☒ No works associated with this drawing

HAZARDS

☐ Working at height
☐ Unusual Access

Interfaces: ☐ Public ☐ Operatives ☐ Vehicle/Plant

WHO COULD BE HARMED?

☐ Construction operatives
☐ Dismantling crew
☐ Future maintenance crew
☐ Public

CONTROL MEASURES

☐ Existing work instruction
☐ Method detailed on drawing
☐ Method detailed on separate document

TEMPORARY WORKS

☐ No temporary works required
☐ Temporary works required and documented separately
☐ Drawing contains temporary works:

☐ Generic or proprietary solution
☐ Specific basic design
☐ Specific design
☐ High risk or specialist design

Complete temporary works design check certificate: DE-SF-081

Red ☒ OK to proceed providing specific design hazards and risks have been recognised, acknowledged and understood by the operation team. Site operatives may require additional instruction/training

Amber ☒ OK to proceed as detailed in existing work instruction or procedure detailed on drawing or separate document.

Green ☒ OK to proceed, no significant design hazards and risks, standard control measures apply.

CDM REGULATIONS RESIDUAL RISKS

Design based hazards are actively eliminated where possible. Where hazards cannot be eliminated, this symbol along with an attached note will identify the hazard and indicate that an action is required by the person supervising the works to manage the design hazard during construction.

Other than those noted, we are not aware of any further residual design risks apart from those that a competent contractor would ordinarily consider.

FOR INFORMATION

COMPOSITE ROUTE MAP REVALIDATION, NO ADDITIONAL HAZARDS.

FIRST ISSUE

REVISION

CHKD APPD

YX/YW ROUTE Clearance

CIRCUIT: YW

SP ENERGY NETWORKS

COMPOSITE ROUTE MAP FOR TOWERS YW-39 TO YW-51

JOB No DATE
DRAWN CHKD
DESIGN APPD

SCALE: 1:5000

DRAWING No. **SPENEL-ACC-050**

SP ENERGY NETWORKS CONTRACT No.

SP ENERGY NETWORKS DRAWING No.

ArcGIS

A1

A B

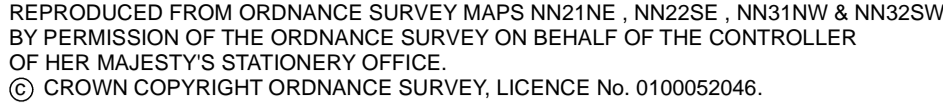

THE LOCATION OF SERVICES SHOWN ON THIS DRAWING IS REPRESENTATIVE ONLY AND MUST NOT BE USED FOR LOCATING SERVICES. USE UTILITY PROVIDER'S DRAWINGS WHEN LOCATING SERVICES ON SITE.

1. UTILITY SEARCH DATE 2016
2. EXISTING UTILITY INFORMATION IS ONLY SHOWN WITHIN THE AREA MARKED AS "UTILITY CORRIDOR OF INTEREST".
3. THIS DRAWING CONTAINS INFORMATION ON THE LOCATION OF UTILITIES IN THE VICINITY OF THE PROPOSED WORKS. IT IS INTENDED TO ASSIST THE SITE TEAM IN IDENTIFYING AND PLANNING THEIR WORKS IN THE VICINITY OF UTILITY HAZARDS ONLY.
4. THE LOCATION OF INDICATED SERVICES IS INDICATIVE ONLY AND SHOULD NOT BE USED AS AN EXACT REFERENCE. TO LOCATE A SERVICE USE UTILITY OWNER'S OWN MAP IN CONJUNCTION WITH SITE BASED SCANNING AND TRIAL HOLES.
5. DO NOT SCALE FROM THIS DRAWING (TOWER SYMBOL LOCATIONS ARE INDICATIVE ONLY).
6. INDICATED ACCESS TRACK ROUTES ARE BASED ON ASSET OWNER'S AGREED WAY LEAVES.
7. IF DEVIATIONS FROM THESE PROPOSED ROUTES ARE REQUIRED, THE CONTRACTOR SHOULD CONTACT THE ASSET OWNERS WAY LEAVE OFFICER AND CONFIRM ACCEPTANCE. IF NEW ROUTE IS OUTSIDE OF THE "UTILITY CORRIDOR OF INTEREST", CONTACT THE DERBY ENGINEERING OFFICE FOR NEW UTILITY DATA.
8. THE SUITABILITY OF ACCESSSES, WORKING PLATFORMS, EXISTING CULVERTS AND BRIDGES FOR THE PROPOSED WORKS SHOULD BE INSPECTED AND ASSESSED BY THE SITE TEAM AND TEMPORARY WORKS COORDINATOR. THE TEMPORARY WORKS COORDINATOR SHOULD ASSESS THE NEED FOR AND THEN SOURCE ANY ENGINEERING SOLUTIONS THAT MAY BE REQUIRED.
9. BALFOUR BEATTY IS NOT RESPONSIBLE FOR THE ACCURACY OF INFORMATION PROVIDED BY THIRD PARTIES, eg AGREED ACCESS ROUTES FROM ASSET OWNER OR UTILITY LOCATIONS FROM THIRD PARTIES.
10. RESPONSES HAVE NOT BEEN RECEIVED FROM

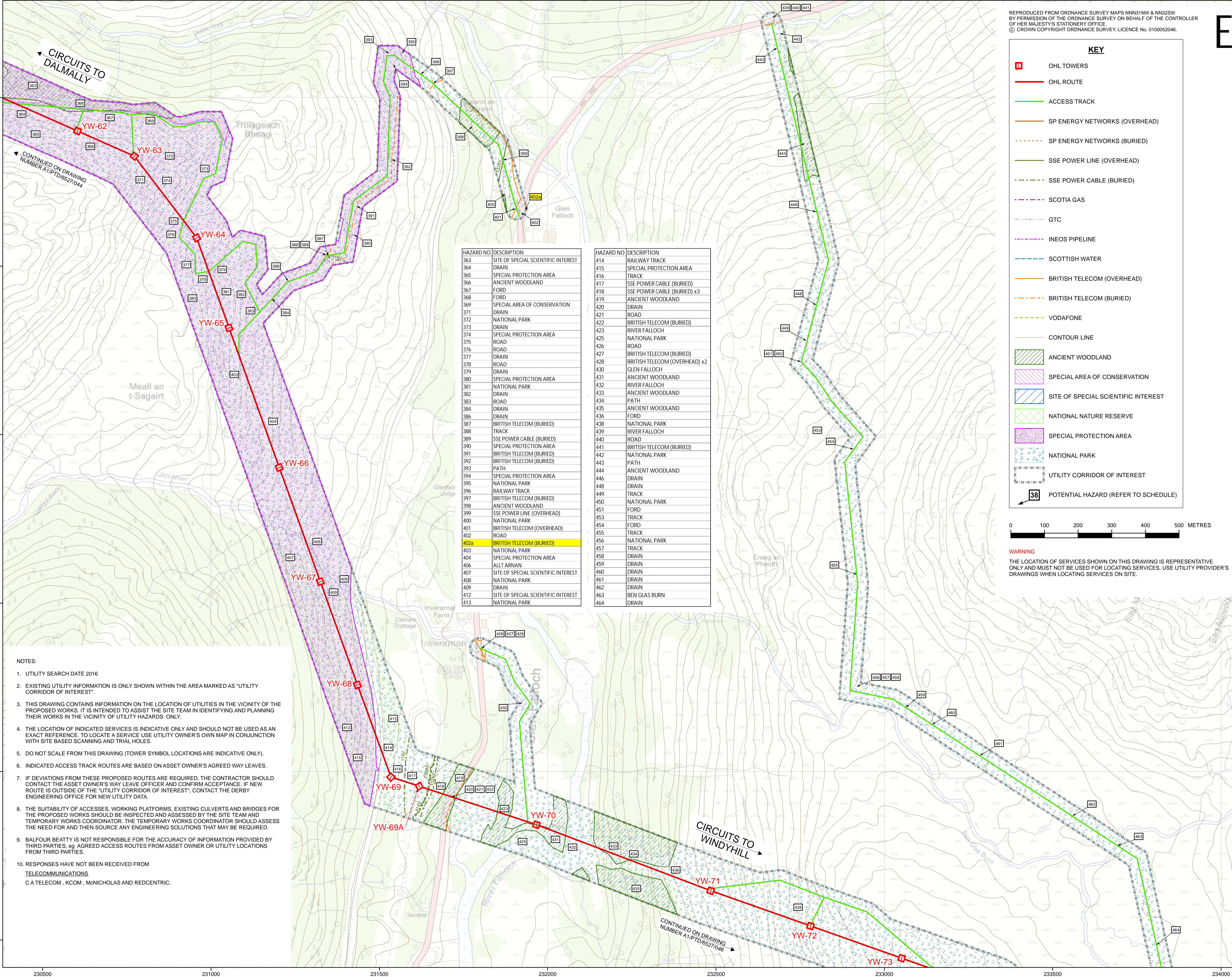

REPRODUCED FROM ORDNANCE SURVEY MAPS NN31NW & NN32SW
BY PERMISSION OF THE ORDNANCE SURVEY ON BEHALF OF THE CONTROLLER
OF HER MAJESTY'S STATIONERY OFFICE.
© CROWN COPYRIGHT ORDNANCE SURVEY, LICENCE No. 0100052046.

KEY

OHL TOWERS

OHL ROUTE

ACCESS TRACK

SP ENERGY NETWORKS (OVERHEAD)

SP ENERGY NETWORKS (BURIED)

SSE POWER LINE (OVERHEAD)

SSE POWER CABLE (BURIED)

SCOTIA GAS

GTC

INEOS PIPELINE

SCOTTISH WATER

BRITISH TELECOM (OVERHEAD)

BRITISH TELECOM (BURIED)

VODAFONE

CONTOUR LINE

ANCIENT WOODLAND

SPECIAL AREA OF CONSERVATION

SITE OF SPECIAL SCIENTIFIC INTEREST

NATIONAL NATURE RESERVE

SPECIAL PROTECTION AREA

NATIONAL PARK

UTILITY CORRIDOR OF INTEREST

POTENTIAL HAZARD (REFER TO SCHEDULE)

0100

100

200

300

400

500

METRES

WARNING

THE LOCATION OF SERVICES SHOWN ON THIS DRAWING IS REPRESENTATIVE ONLY AND MUST NOT BE USED FOR LOCATING SERVICES. USE UTILITY PROVIDER'S DRAWINGS WHEN LOCATING SERVICES ON SITE.

- NOTES:
- UTILITY SEARCH DATE 2016
 - EXISTING UTILITY INFORMATION IS ONLY SHOWN WITHIN THE AREA MARKED AS "UTILITY CORRIDOR OF INTEREST".
 - THIS DRAWING CONTAINS INFORMATION ON THE LOCATION OF UTILITIES IN THE VICINITY OF THE PROPOSED WORKS. IT IS INTENDED TO ASSIST THE SITE TEAM IN IDENTIFYING AND PLANNING THEIR WORKS IN THE VICINITY OF UTILITY HAZARDS ONLY.
 - THE LOCATION OF INDICATED SERVICES IS INDICATIVE ONLY AND SHOULD NOT BE USED AS AN EXACT REFERENCE. TO LOCATE A SERVICE USE UTILITY OWNER'S OWN MAP IN CONJUNCTION WITH SITE BASED SCANNING AND TRIAL HOLES.
 - DO NOT SCALE FROM THIS DRAWING (TOWER SYMBOL LOCATIONS ARE INDICATIVE ONLY).
 - INDICATED ACCESS TRACK ROUTES ARE BASED ON ASSET OWNER'S AGREED WAY LEAVES.
 - IF DEVIATIONS FROM THESE PROPOSED ROUTES ARE REQUIRED, THE CONTRACTOR SHOULD CONTACT THE ASSET OWNER'S WAY LEAVE OFFICER AND CONFIRM ACCEPTANCE. IF NEW ROUTE IS OUTSIDE OF THE "UTILITY CORRIDOR OF INTEREST", CONTACT THE DERBY ENGINEERING OFFICE FOR NEW UTILITY DATA.
 - THE SUITABILITY OF ACCESSES, WORKING PLATFORMS, EXISTING CULVERTS AND BRIDGES FOR THE PROPOSED WORKS SHOULD BE INSPECTED AND ASSESSED BY THE SITE TEAM AND TEMPORARY WORKS COORDINATOR. THE TEMPORARY WORKS COORDINATOR SHOULD ASSESS THE NEED FOR AND THEN SOURCE ANY ENGINEERING SOLUTIONS THAT MAY BE REQUIRED.
 - BALFOUR BEATTY IS NOT RESPONSIBLE FOR THE ACCURACY OF INFORMATION PROVIDED BY THIRD PARTIES. eg AGREED ACCESS ROUTES FROM ASSET OWNER OR UTILITY LOCATIONS FROM THIRD PARTIES.
 - RESPONSES HAVE NOT BEEN RECEIVED FROM
TELECOMMUNICATIONS
CA TELECOM, KCOM, McNICHOLAS AND REDCENTRIC.

HAZARD NO	DESCRIPTION	HAZARD NO	DESCRIPTION
363	SITE OF SPECIAL SCIENTIFIC INTEREST	414	RAILWAY TRACK
364	DRAIN	415	SPECIAL PROTECTION AREA
365	SPECIAL PROTECTION AREA	416	TRACK
366	ANCIENT WOODLAND	417	SSE POWER CABLE (BURIED)
367	FORD	418	SSE POWER CABLE (BURIED) x3
368	FORD	419	ANCIENT WOODLAND
369	SPECIAL AREA OF CONSERVATION	420	DRAIN
371	DRAIN	421	ROAD
372	NATIONAL PARK	422	BRITISH TELECOM (BURIED)
373	DRAIN	423	RIVER FALLOCH
374	SPECIAL PROTECTION AREA	425	NATIONAL PARK
375	ROAD	426	ROAD
376	ROAD	427	BRITISH TELECOM (BURIED)
377	DRAIN	428	BRITISH TELECOM (OVERHEAD) x2
378	ROAD	430	GLEN FALLOCH
379	DRAIN	431	ANCIENT WOODLAND
380	SPECIAL PROTECTION AREA	432	RIVER FALLOCH
381	NATIONAL PARK	433	ANCIENT WOODLAND
382	DRAIN	434	PATH
383	ROAD	435	ANCIENT WOODLAND
384	DRAIN	436	FORD
386	BRITISH TELECOM (BURIED)	438	NATIONAL PARK
387	TRACK	439	RIVER FALLOCH
388	SSE POWER CABLE (BURIED)	440	ROAD
389	SPECIAL PROTECTION AREA	441	BRITISH TELECOM (BURIED)
390	BRITISH TELECOM (BURIED)	442	NATIONAL PARK
391	BRITISH TELECOM (BURIED)	443	PATH
392	BRITISH TELECOM (BURIED)	444	ANCIENT WOODLAND
393	PATH	446	DRAIN
394	SPECIAL PROTECTION AREA	448	DRAIN
395	NATIONAL PARK	449	TRACK
396	RAILWAY TRACK	450	NATIONAL PARK
397	BRITISH TELECOM (BURIED)	451	FORD
398	ANCIENT WOODLAND	453	TRACK
399	SSE POWER LINE (OVERHEAD)	454	FORD
400	NATIONAL PARK	455	TRACK
401	BRITISH TELECOM (OVERHEAD)	456	NATIONAL PARK
402	ROAD	457	TRACK
402a	BRITISH TELECOM (BURIED)	458	DRAIN
403	NATIONAL PARK	459	DRAIN
404	SPECIAL PROTECTION AREA	460	DRAIN
406	ALLT ARNAN	461	DRAIN
407	SITE OF SPECIAL SCIENTIFIC INTEREST	462	DRAIN
408	NATIONAL PARK	463	BEN GLAS BURN
409	DRAIN	464	DRAIN
412	SITE OF SPECIAL SCIENTIFIC INTEREST		
413	NATIONAL PARK		

FOR INFORMATION

B	COMPOSITE ROUTE MAP REVALUATION: NEW HAZARDS SHOWN YELLOW.				
A		FIRST ISSUE			
ISSUE	DATE	REVISION	CHKD	APPD	
YX/YW ROUTE Clearance					
CIRCUIT:- YW					
TITLE:- COMPOSITE ROUTE MAP FOR TOWERS YW-62 TO YW-73					
JOB No	DATE				
DRAWN	CHKD				
DESIGN	APPD				
SCALE:- 1:5000					
DRAWING No. SPENEL-ACC-073					
SP ENERGY NETWORKS CONTRACT No.					ArcGIS
SP ENERGY NETWORKS DRAWING No.					A1
A	B				

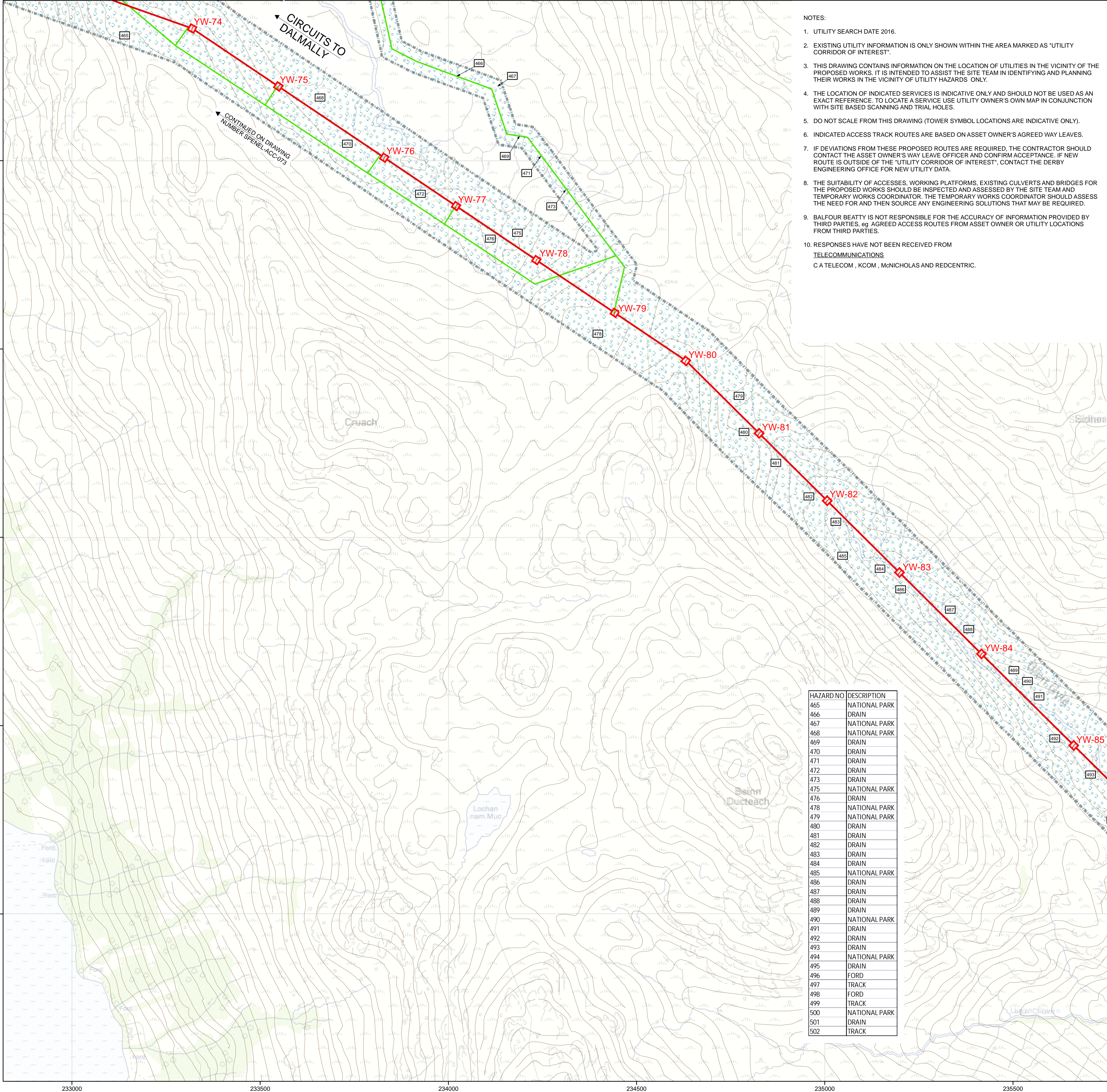

- NOTES:
1. UTILITY SEARCH DATE 2016.
 2. EXISTING UTILITY INFORMATION IS ONLY SHOWN WITHIN THE AREA MARKED AS 'UTILITY CORRIDOR OF INTEREST'.
 3. THIS DRAWING CONTAINS INFORMATION ON THE LOCATION OF UTILITIES IN THE VICINITY OF THE PROPOSED WORKS. IT IS INTENDED TO ASSIST THE SITE TEAM IN IDENTIFYING AND PLANNING THEIR WORKS IN THE VICINITY OF UTILITY HAZARDS ONLY.
 4. THE LOCATION OF INDICATED SERVICES IS INDICATIVE ONLY AND SHOULD NOT BE USED AS AN EXACT REFERENCE. TO LOCATE A SERVICE USE UTILITY OWNER'S OWN MAP IN CONJUNCTION WITH SITE BASED SCANNING AND TRIAL HOLES.
 5. DO NOT SCALE FROM THIS DRAWING (TOWER SYMBOL LOCATIONS ARE INDICATIVE ONLY).
 6. INDICATED ACCESS TRACK ROUTES ARE BASED ON ASSET OWNER'S AGREED WAY LEAVES.
 7. IF DEVIATIONS FROM THESE PROPOSED ROUTES ARE REQUIRED, THE CONTRACTOR SHOULD CONTACT THE ASSET OWNER'S WAY LEAVE OFFICER AND CONFIRM ACCEPTANCE. IF NEW ROUTE IS OUTSIDE OF THE 'UTILITY CORRIDOR OF INTEREST', CONTACT THE DERBY ENGINEERING OFFICE FOR NEW UTILITY DATA.
 8. THE SUITABILITY OF ACCESSES, WORKING PLATFORMS, EXISTING CULVERTS AND BRIDGES FOR THE PROPOSED WORKS SHOULD BE INSPECTED AND ASSESSED BY THE SITE TEAM AND TEMPORARY WORKS COORDINATOR. THE TEMPORARY WORKS COORDINATOR SHOULD ASSESS THE NEED FOR AND THEN SOURCE ANY ENGINEERING SOLUTIONS THAT MAY BE REQUIRED.
 9. BALFOUR BEATTY IS NOT RESPONSIBLE FOR THE ACCURACY OF INFORMATION PROVIDED BY THIRD PARTIES, eg AGREED ACCESS ROUTES FROM ASSET OWNER OR UTILITY LOCATIONS FROM THIRD PARTIES.
 10. RESPONSES HAVE NOT BEEN RECEIVED FROM
TELECOMMUNICATIONS
C A TELECOM , KCOM , McNICHOLAS AND REDCENTRIC.

REPRODUCED FROM ORDNANCE SURVEY MAPS NN31SW , NN31NW , NN31NE & NN31SE
BY PERMISSION OF THE ORDNANCE SURVEY ON BEHALF OF THE CONTROLLER
OF HER MAJESTY'S STATIONERY OFFICE.
© CROWN COPYRIGHT ORDNANCE SURVEY, LICENCE No. 0100052046.

KEY

OHL TOWERS

OHL ROUTE

ACCESS TRACK

SP ENERGY NETWORKS (OVERHEAD)

SP ENERGY NETWORKS (BURIED)

SSE POWER LINE (OVERHEAD)

SSE POWER CABLE (BURIED)

SCOTIA GAS

GTC

INEOS PIPELINE

SCOTTISH WATER

BRITISH TELECOM (OVERHEAD)

BRITISH TELECOM (BURIED)

VODAFONE

CONTOUR LINE

ANCIENT WOODLAND

SPECIAL AREA OF CONSERVATION

SITE OF SPECIAL SCIENTIFIC INTEREST

NATIONAL NATURE RESERVE

SPECIAL PROTECTION AREA

NATIONAL PARK

UTILITY CORRIDOR OF INTEREST

38

POTENTIAL HAZARD (REFER TO SCHEDULE)

0100200300400500

METRES

WARNING
THE LOCATION OF SERVICES SHOWN ON THIS DRAWING IS REPRESENTATIVE ONLY AND MUST NOT BE USED FOR LOCATING SERVICES. USE UTILITY PROVIDER'S DRAWINGS WHEN LOCATING SERVICES ON SITE.

HAZARD NO	DESCRIPTION
465	NATIONAL PARK
466	DRAIN
467	NATIONAL PARK
468	NATIONAL PARK
469	DRAIN
470	DRAIN
471	DRAIN
472	DRAIN
473	DRAIN
475	NATIONAL PARK
476	DRAIN
478	NATIONAL PARK
479	NATIONAL PARK
480	DRAIN
481	DRAIN
482	DRAIN
483	DRAIN
484	DRAIN
485	NATIONAL PARK
486	DRAIN
487	DRAIN
488	DRAIN
489	DRAIN
490	NATIONAL PARK
491	DRAIN
492	DRAIN
493	DRAIN
494	NATIONAL PARK
495	DRAIN
496	FORD
497	TRACK
498	FORD
499	TRACK
500	NATIONAL PARK
501	DRAIN
502	TRACK

Designer's Site Specific Risk Assessment

By:Date:

XNo works associated with this drawing

HAZARDS

Working at height

Unusual Access

Site fabrication/drilling

Excavation

Interfaces:PublicOperativesVehicle/Plant

WHO COULD BE HARMED?

Construction operatives

Dismantling crew

Future maintenance crew

Public

Existing work instruction

Method detailed on drawing

Method detailed on separate document

TEMPORARY WORKS

No temporary works required

Temporary works required and documented separately

Drawing contains temporary works:

0Generic or proprietary solution

1Specific basic design

2Specific design

3High risk or specialist design

Complete temporary works design check certificate: DE-SF-081

RedOK to proceed providing specific design hazards and risks have been recognised, acknowledged and understood by the operation team. Site operatives may require additional instruction/training

AmberXOK to proceed as detailed in existing work instruction or procedure detailed on drawing or separate document.

GreenOK to proceed, no significant design hazards and risks, standard control measures apply.

CDM REGULATIONS RESIDUAL RISKS

Design based hazards are actively eliminated where possible. Where hazards cannot be eliminated, this symbol along with an attached note will identify the hazard and indicate that an action is required by the person supervising the works to manage the design hazard during construction.

Other than those noted, we are not aware of any further residual design risks apart from those that a competent contractor would ordinarily consider.

FOR INFORMATION

B

A

ISSUE

DATE

DNB

COMPOSITE ROUTE MAP

REVALIDATION, NO ADDITIONAL HAZARDS.

FIRST ISSUE

REVISION

CHKD

APPD

YX/YW ROUTE Clearance

CIRCUIT:-

YW

SP ENERGY NETWORKS

TITLE:-

COMPOSITE ROUTE MAP FOR TOWERS YW-74 TO YW-88

JOB No

DRAWN

DESIGN

DATE

CHKD

APPD

SCALE:-

1:5000

DRAWING No.

SPENEL-ACC-088

SP ENERGY NETWORKS CONTRACT No.

ArcGIS

SP ENERGY NETWORKS DRAWING No.

A1

A

B

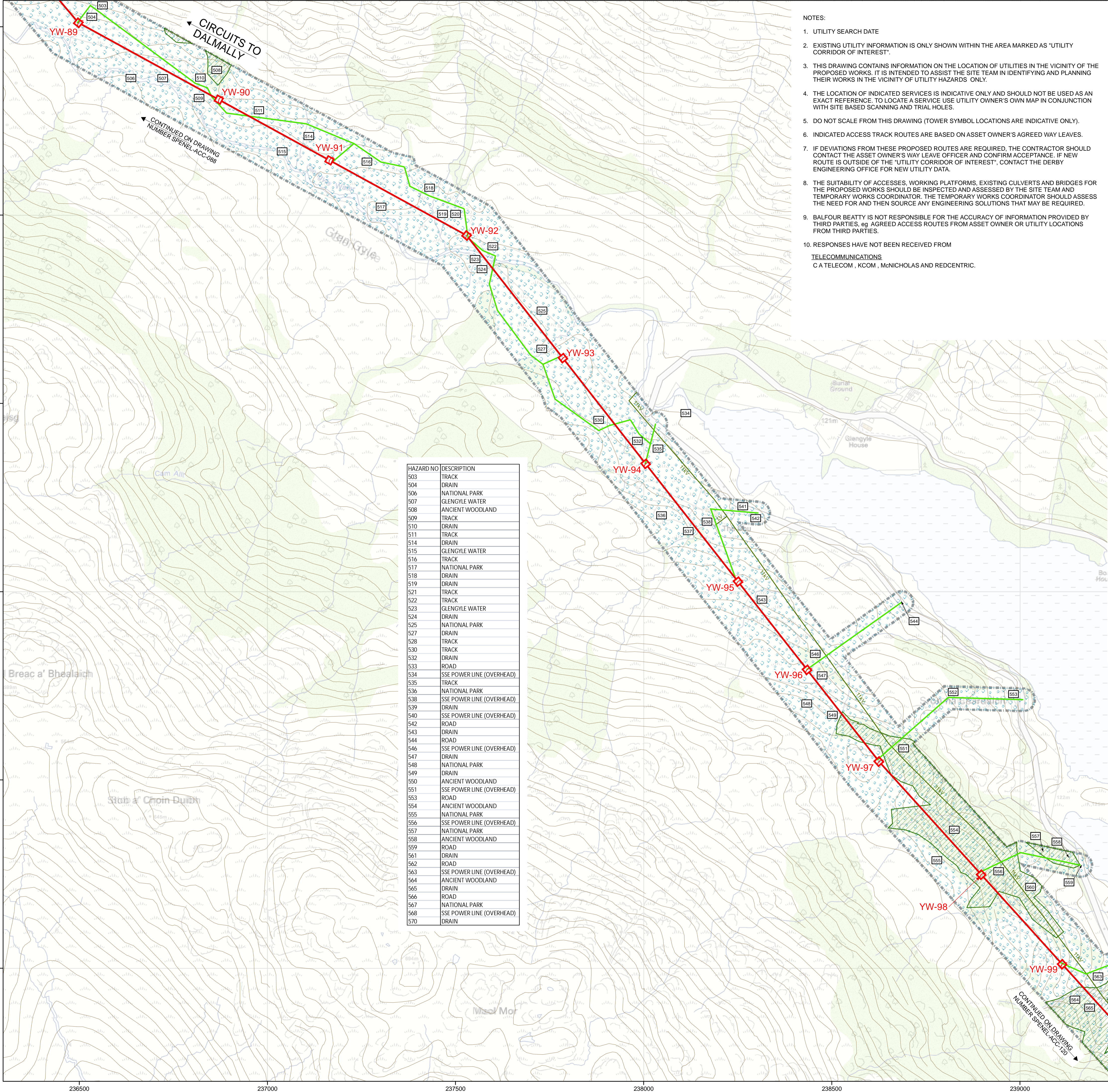

HAZARD NO	DESCRIPTION
503	TRACK
504	DRAIN
506	NATIONAL PARK
507	GLENGYLE WATER
508	ANCIENT WOODLAND
509	TRACK
510	DRAIN
511	TRACK
514	DRAIN
515	GLENGYLE WATER
516	TRACK
517	NATIONAL PARK
518	DRAIN
519	TRACK
521	TRACK
522	TRACK
523	GLENGYLE WATER
524	DRAIN
525	NATIONAL PARK
527	DRAIN
528	TRACK
530	TRACK
532	DRAIN
533	ROAD
534	SSE POWER LINE (OVERHEAD)
535	TRACK
536	NATIONAL PARK
538	SSE POWER LINE (OVERHEAD)
539	DRAIN
540	SSE POWER LINE (OVERHEAD)
542	ROAD
543	DRAIN
544	ROAD
546	SSE POWER LINE (OVERHEAD)
547	DRAIN
548	NATIONAL PARK
549	DRAIN
550	ANCIENT WOODLAND
551	SSE POWER LINE (OVERHEAD)
553	ROAD
554	ANCIENT WOODLAND
555	NATIONAL PARK
556	SSE POWER LINE (OVERHEAD)
557	NATIONAL PARK
558	ANCIENT WOODLAND
559	ROAD
561	DRAIN
562	ROAD
563	SSE POWER LINE (OVERHEAD)
564	ANCIENT WOODLAND
565	DRAIN
566	ROAD
567	NATIONAL PARK
568	SSE POWER LINE (OVERHEAD)
570	DRAIN

- NOTES:
- UTILITY SEARCH DATE
 - EXISTING UTILITY INFORMATION IS ONLY SHOWN WITHIN THE AREA MARKED AS 'UTILITY CORRIDOR OF INTEREST'.
 - THIS DRAWING CONTAINS INFORMATION ON THE LOCATION OF UTILITIES IN THE VICINITY OF THE PROPOSED WORKS. IT IS INTENDED TO ASSIST THE SITE TEAM IN IDENTIFYING AND PLANNING THEIR WORKS IN THE VICINITY OF UTILITY HAZARDS ONLY.
 - THE LOCATION OF INDICATED SERVICES IS INDICATIVE ONLY AND SHOULD NOT BE USED AS AN EXACT REFERENCE. TO LOCATE A SERVICE USE UTILITY OWNER'S OWN MAP IN CONJUNCTION WITH SITE BASED SCANNING AND TRIAL HOLES.
 - DO NOT SCALE FROM THIS DRAWING (TOWER SYMBOL LOCATIONS ARE INDICATIVE ONLY).
 - INDICATED ACCESS TRACK ROUTES ARE BASED ON ASSET OWNER'S AGREED WAY LEAVES.
 - IF DEVIATIONS FROM THESE PROPOSED ROUTES ARE REQUIRED, THE CONTRACTOR SHOULD CONTACT THE ASSET OWNER'S WAY LEAVE OFFICER AND CONFIRM ACCEPTANCE. IF NEW ROUTE IS OUTSIDE OF THE 'UTILITY CORRIDOR OF INTEREST', CONTACT THE DERBY ENGINEERING OFFICE FOR NEW UTILITY DATA.
 - THE SUITABILITY OF ACCESSES, WORKING PLATFORMS, EXISTING CULVERTS AND BRIDGES FOR THE PROPOSED WORKS SHOULD BE INSPECTED AND ASSESSED BY THE SITE TEAM AND TEMPORARY WORKS COORDINATOR. THE TEMPORARY WORKS COORDINATOR SHOULD ASSESS THE NEED FOR AND THEN SOURCE ANY ENGINEERING SOLUTIONS THAT MAY BE REQUIRED.
 - BALFOUR BEATTY IS NOT RESPONSIBLE FOR THE ACCURACY OF INFORMATION PROVIDED BY THIRD PARTIES, eg AGREED ACCESS ROUTES FROM ASSET OWNER OR UTILITY LOCATIONS FROM THIRD PARTIES.
 - RESPONSES HAVE NOT BEEN RECEIVED FROM
- TELECOMMUNICATIONS
C A TELECOM , KCOM , McNICHOLAS AND REDCENTRIC.

REPRODUCED FROM ORDNANCE SURVEY MAP NN31SE
BY PERMISSION OF THE ORDNANCE SURVEY ON BEHALF OF THE CONTROLLER
OF HER MAJESTY'S STATIONERY OFFICE.
© CROWN COPYRIGHT ORDNANCE SURVEY, LICENCE No. 0100052046.

KEY

OHL TOWERS

OHL ROUTE

ACCESS TRACK

SP ENERGY NETWORKS (OVERHEAD)

SP ENERGY NETWORKS (BURIED)

SSE POWER LINE (OVERHEAD)

SSE POWER CABLE (BURIED)

SCOTIA GAS

GTC

INEOS PIPELINE

SCOTTISH WATER

BRITISH TELECOM (OVERHEAD)

BRITISH TELECOM (BURIED)

VODAFONE

CONTOUR LINE

ANCIENT WOODLAND

SPECIAL AREA OF CONSERVATION

SITE OF SPECIAL SCIENTIFIC INTEREST

NATIONAL NATURE RESERVE

SPECIAL PROTECTION AREA

NATIONAL PARK

UTILITY CORRIDOR OF INTEREST

POTENTIAL HAZARD (REFER TO SCHEDULE)

0100200300400500METRES

WARNING

THE LOCATION OF SERVICES SHOWN ON THIS DRAWING IS REPRESENTATIVE ONLY AND MUST NOT BE USED FOR LOCATING SERVICES. USE UTILITY PROVIDER'S DRAWINGS WHEN LOCATING SERVICES ON SITE.

Designer's Site Specific Risk Assessment

By:Date:

No works associated with this drawing

HAZARDS

Working at height

Unusual Access

Site fabrication/drilling

Excavation

Interfaces:

Public

Operatives

Vehicle/Plant

WHO COULD BE HARMED?

Construction operatives

Dismantling crew

Future maintenance crew

Public

CONTROL MEASURES

Existing work instruction

Method detailed on drawing

Method detailed on separate document

TEMPORARY WORKS

No temporary works required

Temporary works required and documented separately

Drawing contains temporary works:

0

Generic or proprietary solution

1

Specific basic design

2

Specific design

3

High risk or specialist design

Complete temporary works design check certificate: DE-SF-081

OK to proceed providing specific design hazards and risks have been recognised, acknowledged and understood by the operation team. Site operatives may require additional instruction/training

OK to proceed as detailed in existing work instruction or procedure detailed on drawing or separate document.

OK to proceed, no significant design hazards and risks, standard control measures apply.

CDM REGULATIONS RESIDUAL RISKS

Design based hazards are actively eliminated where possible. Where hazards cannot be eliminated, this symbol along with an attached note will identify the hazard and indicate that an action is required by the person supervising the works to manage the design hazard during construction.

Other than those noted, we are not aware of any further residual design risks apart from those that a competent contractor would ordinarily consider.

B

A

ISSUE

DATE

DRN

REVISION

CHKD

APPD

COMPOSITE ROUTE MAP

REVALIDATION, NO ADDITIONAL HAZARDS.

FIRST ISSUE

YX/YW ROUTE Clearance

YW

SP ENERGY NETWORKS

TITLE:

COMPOSITE ROUTE MAP FOR TOWERS YW-89 TO YW-100

JOB No

DATE

DRAWN

CHKD

DESIGN

APPD

SCALE:1:5000

DRAWING No.SPENEL-ACC-100

SP ENERGY NETWORKS CONTRACT No.

ArcGIS

SP ENERGY NETWORKS DRAWING No.

A1

A

B

B